

Tile Platforms

construction manual

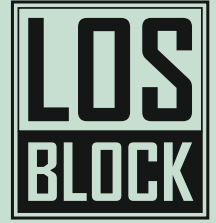

wargame scenery
&
accessories

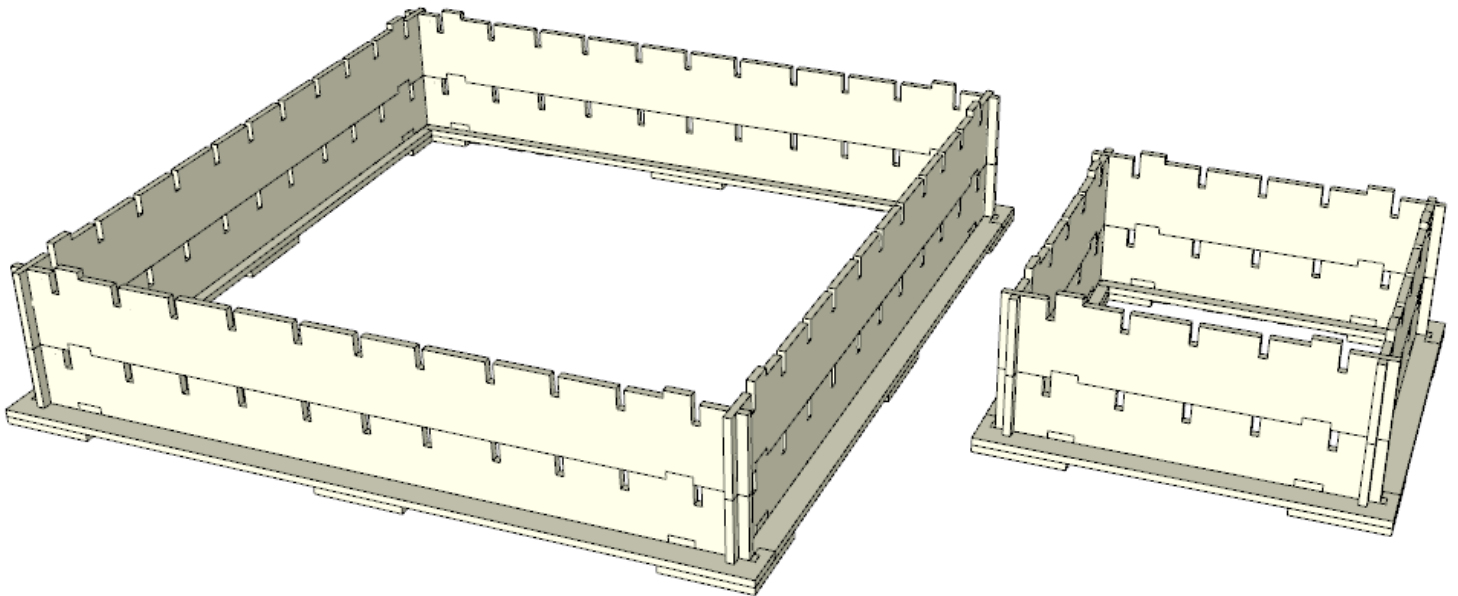

Material: HDF

Push details from the form and clear the places where it were connected with model knife or flint-paper.
Be sure that protection cover on the methacrylate parts (if they are included) is removed.

We are recommend to use PVA glue or any other glue for wood.
For methacrylate parts you can use super-glue or its equivalents.
If you have any questions write us - store@losblock.com

Small parts. Not recommended for children under 6 years.
Real object can slightly differ from presented in this manual.

© LOSBLOCK, 2018
www.losblock.com

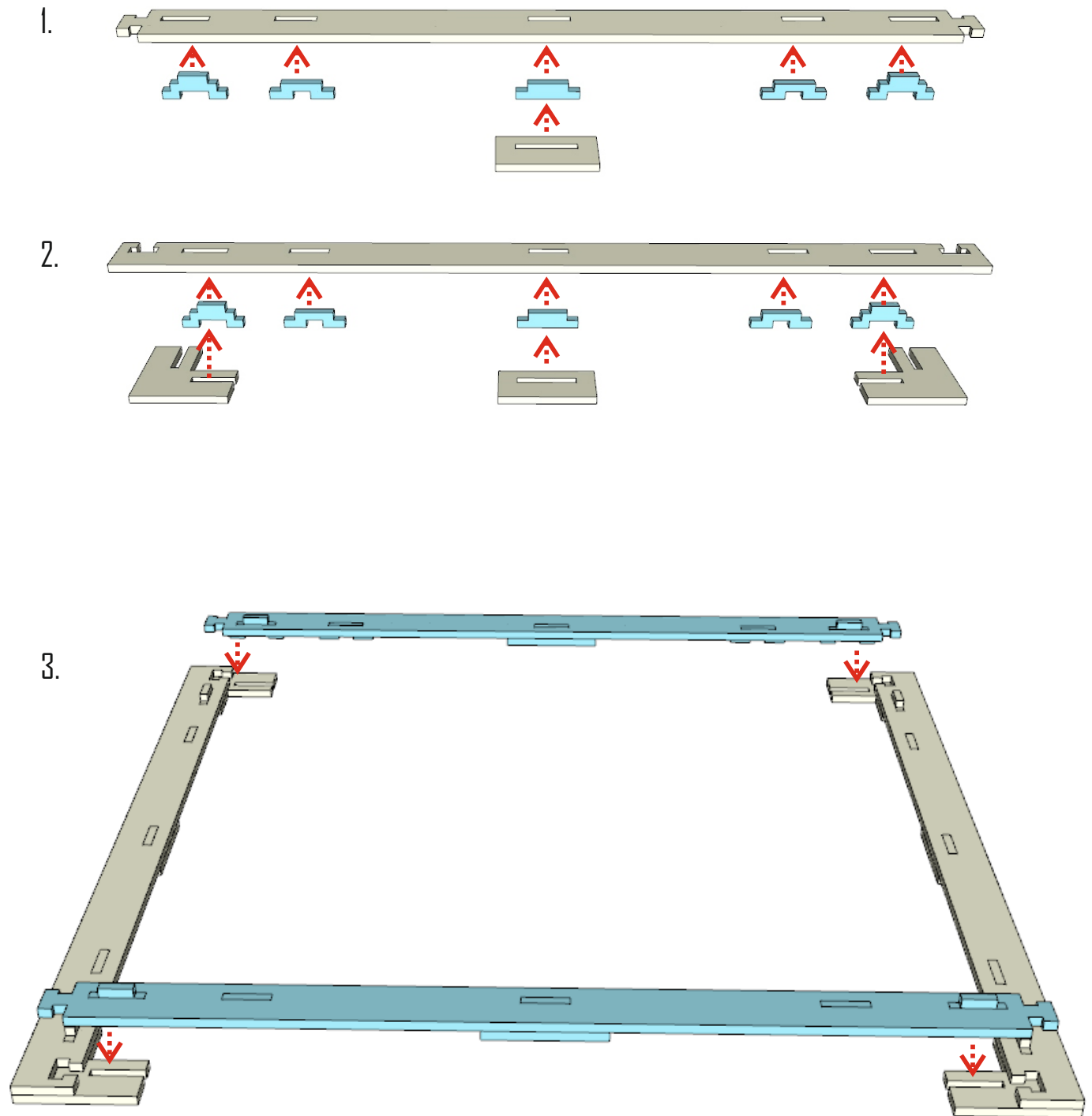

If you want to make the platform disassemblable - do not glue this parts together.

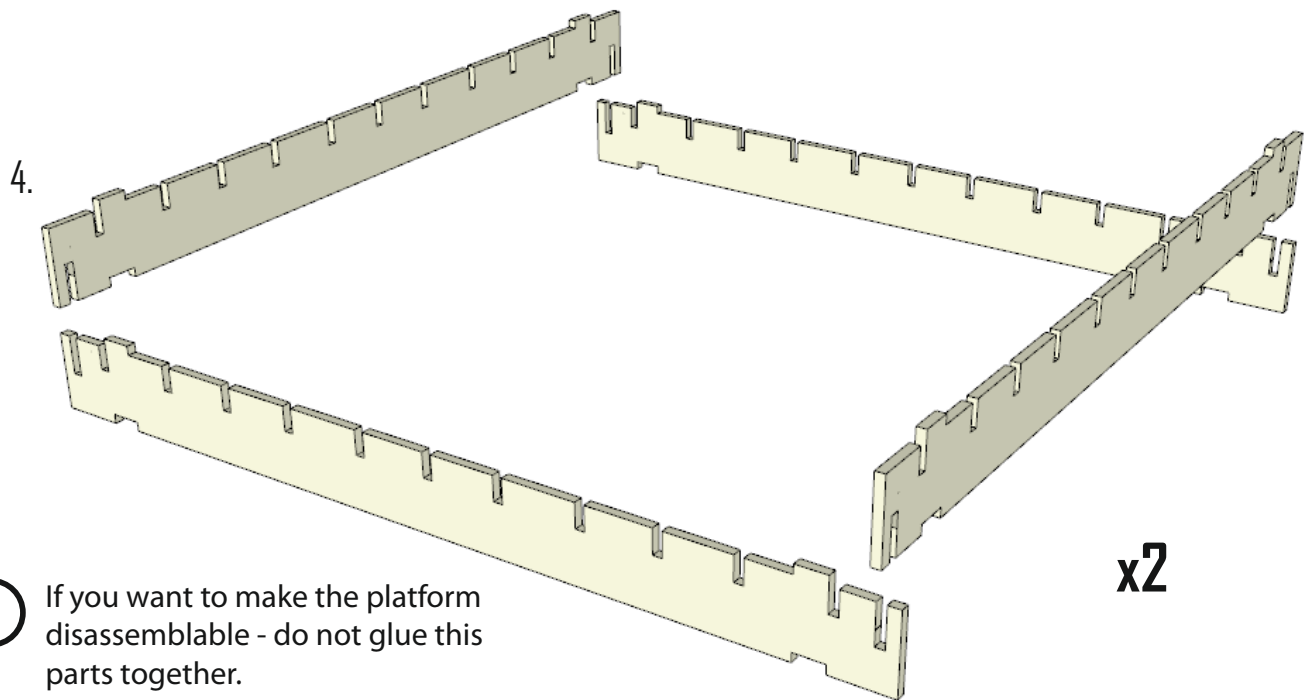

⚠ If you want to make the platform disassemblable - do not glue this parts together.

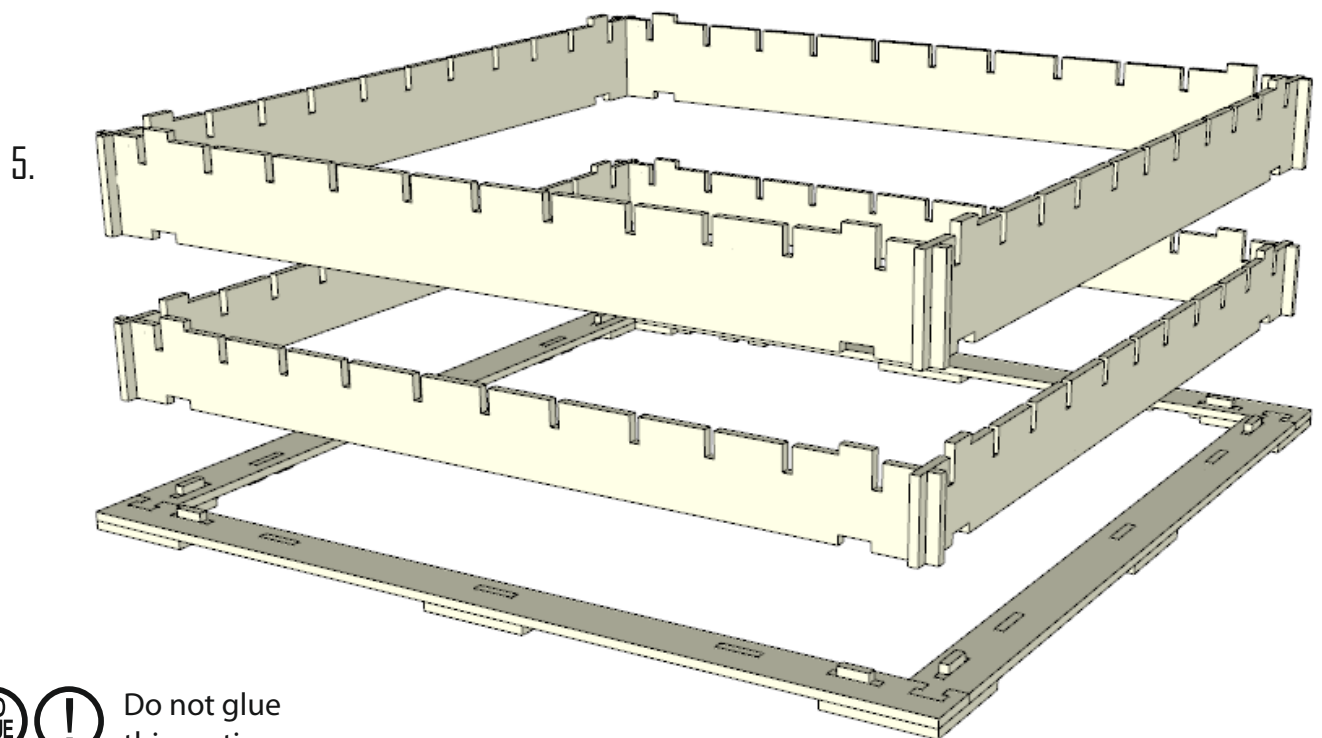

NO
GLUE



Do not glue
this sections.



Lower section should be
in the middle.

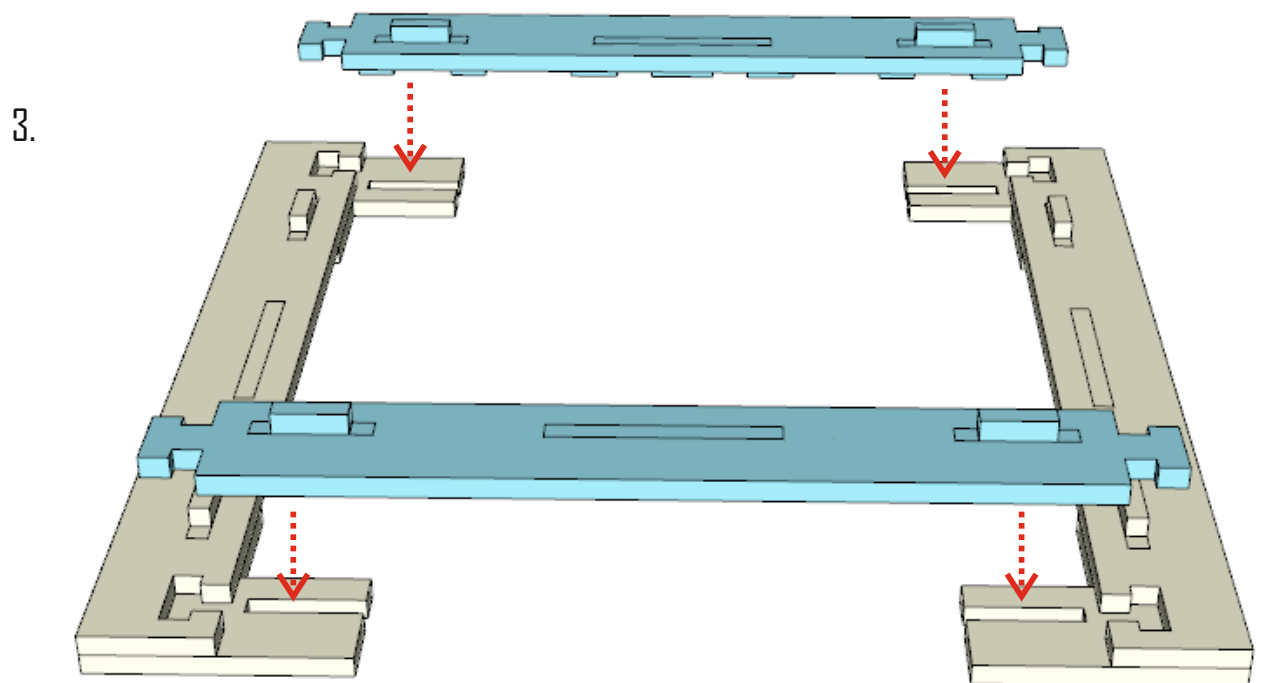
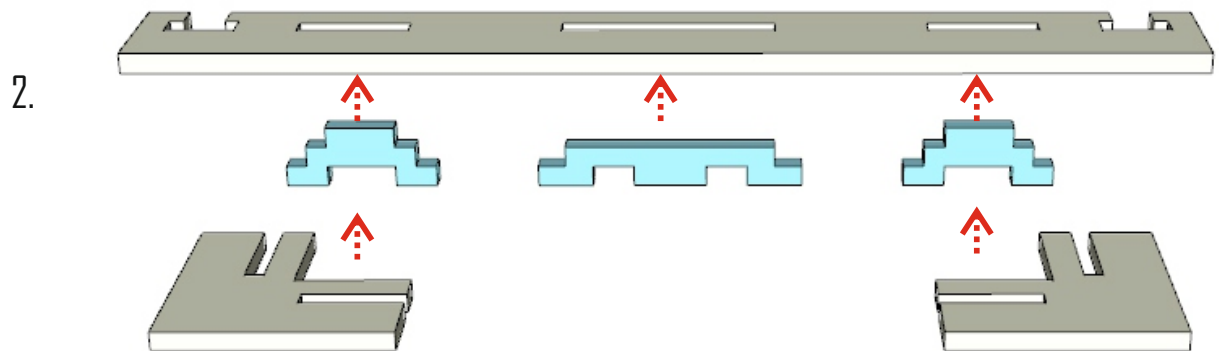
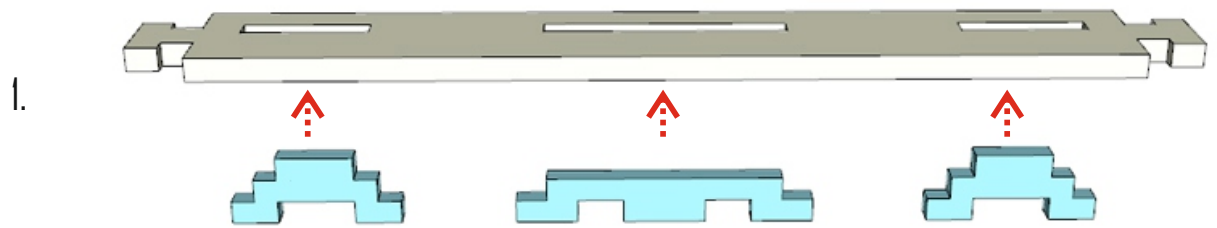

If you want to make the platform disassemblable - do not glue this parts together.

